



Quality – Service – Commitment – Delivered.

MAXI300



12" [300] WIDE THROAT TRENCH DRAIN SYSTEM WITH DUCTILE IRON FRAME

Dimensional Data (inches and [mm]) are Subject to Manufacturing Tolerances and Change Without Notice

ENGINEERING SPECIFICATION: HYDROTEC MAXI300 Channels shall be 39.37" [1000] long, 14.96" [380] wide reveal and have a 11.81" [300] wide throat. Modular channel sections shall be made of fiber-reinforced concrete C35/45. Shall have a male/female connection between channel sections that will not separate during the installation. Channels shall have a radiused self-cleaning bottom and neutral 0% built in slope. Channels shall have Ductile Iron Edge Rails built into the fiber-reinforced concrete. Channels shall have all grates locked down as per HYDROTEC's "F1" locking mechanism.

MAXI 11.81" [300] wide throat **Ductile Iron ADA Grate is rated class E** per the DIN EN1433 top load classifications. Ductile Iron conforms to ASTM specification A536-84, Grade 80-55-06. Supplied in 39.37" [1000] or 19.69" [500] nominal lengths with 1.02/0.47 [26/12] wide slots. Grate has an open area of 52.91 sq. in per ft. [112,000 sq.mm per meter].

MAXI 11.81" [300] wide throat **Ductile Iron ADA Grate is rated class F** per the DIN EN1433 top load classifications. Ductile Iron conforms to ASTM specification A536-84, Grade 80-55-06. Supplied in 39.37" [1000] or 19.69" [500] nominal lengths with 1.02/0.47 [26/12] wide slots. Grate has an open area of 52.91 sq. in per ft. [112,000 sq.mm per meter].

MAXI300 Parts Guide

Product Description	With Ductile Iron Class E Grate Part No.	Weight Lbs	With Ductile Iron ADA Class F Grate Part No.	Weight Lbs	'A' Shallow Invert Inches [mm]	'B' Shallow Invert Inches [mm]
Neutral Channel 39.37" (1m)	CHG66350-0501	396.83	CHG66360-0501	436.51	15.75"[400]	15.75"[400]
Neutral Channel 19.69" (0.5m)	CHG66350-0551	198.41	CHG66360-0551	202.82	15.75"[400]	15.75"[400]
Catch Basin 19.69" (0.5m)	CHG66350-0081	306.44	CHG66360-0081	306.44	29.53"[750]	29.53"[750]
Neutral Channel 39.37" (1m) with Precast Outlet Underneath	CHG66350-0571	396.83	CHG66360-0571	436.51	15.75"[400]	15.75"[400]

ACCESSORIES MAXI300	Part. No
Closed End Cap for MAXI300 made out of Cast Iron	CHG70031-11
8" Pipe Connection (PVC) for all MAXI300	CHG70022-00

MAXI300 with Ductile Iron ADA Load Class E (Part No. CHG66350-*) and ADA Load Class F (Part No. CHG66360-*)

Channel with 2 grates, water intake area 173.60 sq. ins

Water Intake area 86.80 sq. ins

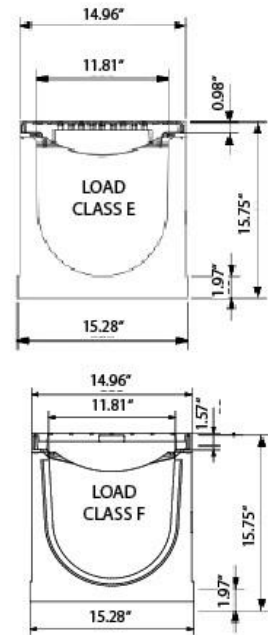
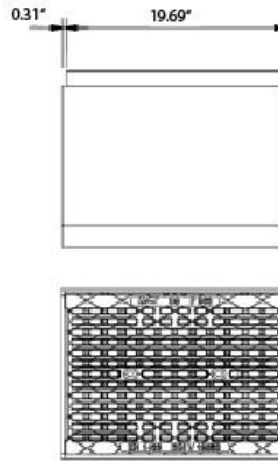
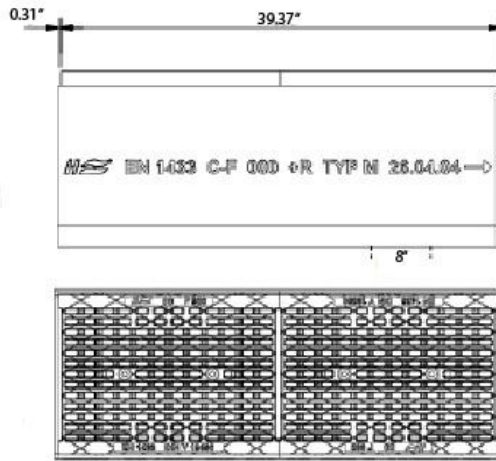

Catch Basin and End Caps for All MAXI300

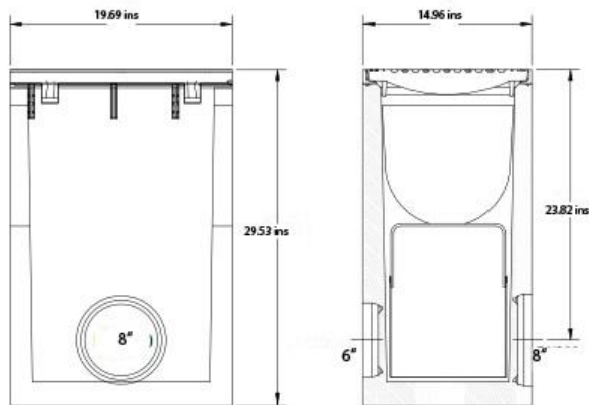

Catch Basin includes
galvanized dirt catcher

Closed End Cap
Iron (CHG70031-11)