

ZIP FLANGE ZF2 SET SCREW ADAPTER FOR DUCTILE IRON OR STEEL PIPE TO FLANGE FITTING, PUMP, VALVE

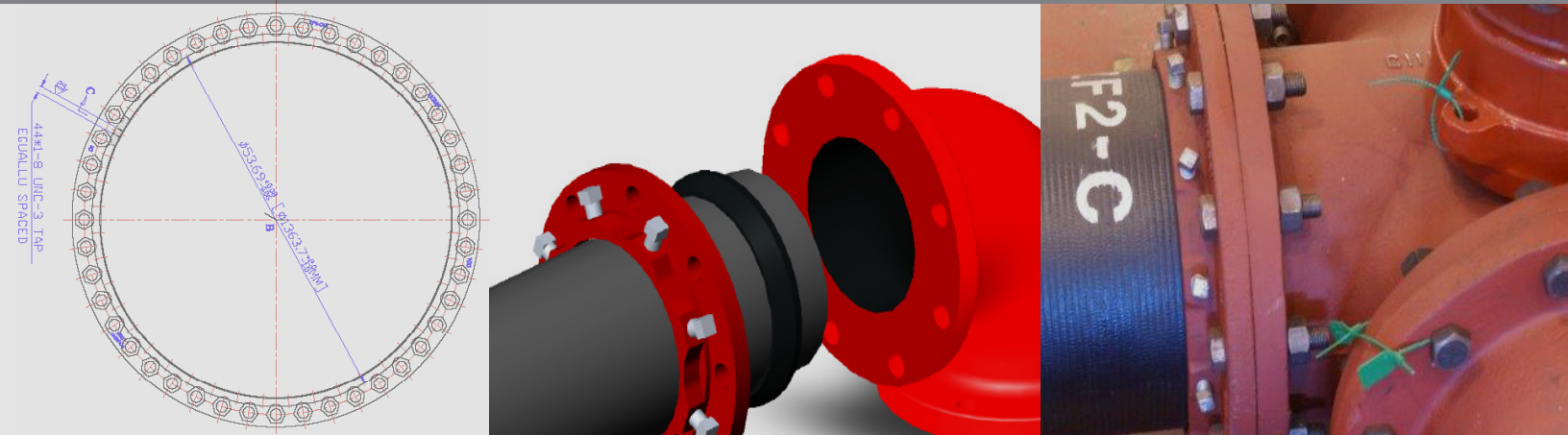

PRODUCT SPECIFICATIONS

MATERIAL:

- Adapter flange sleeve is manufactured of high strength ductile iron in accordance with ASTM A536, Grade 65-45-12.
- Gasket is manufactured of SBR and alternative materials like EPDM, NBR, and CR are available upon request.
- Set screws are manufactured from AISI 4140 steel, heat-treated and zinc-plated.

SIZE RANGE:

- 2" through 12"

DIMENSION:

- Manufactured in accordance with ANSI/AWWA C110/A21.10 and ASME B16.1 standards.

PRESSURE RATINGS:

- 200 psi on sizes 2"-8" and 175 psi on 10"-12"

COATING:

- Red Alkyd paint

TRACEABILITY:

- Adapter flange is individually cast with exact heat code information.

INSTALLATION:

- In accordance with manufacturer's recommendation and applicable AWWA/ANSI standards.



Note: For 14" & above sizes please refer SFUP series

Note: This product is not designed to be used on plain end fittings.

October 2022 SIGMA Corporation www.sigmaco.com