

# ONE-LOK™ MODEL SLIDE WEDGE ACTION RESTRAINT FOR DUCTILE IRON PIPE

<b>Project Name:</b>	<b>Contractor:</b>	<b>Date</b>
<b>Engineer:</b>	<b>Spec Section:</b>	

## Optional Specifications

<b>Bolts &amp; Nuts</b>	High Strength, Low Alloy Steel (HSLA) <i>(In accordance with ANSI/AWWA C111/A21.11)</i>	<b>Gaskets</b>	SBR <i>(In accordance with ANSI/AWWA C111/A21.11)</i>
	Stainless Steel ___Type 304 ___Type 316		EPDM
	Blue Fluoropolymer		Neoprene
	<b>Other-</b> Specify		Nitrile
			<b>Other-</b> Specify
<b>Coating</b>	Asphaltic Black Enamel		
	Electro-deposition "CORRSAFE™"		

## Product Specifications

<b>Material:</b>	Gland body, wedge inserts and break-off top actuating bolts are manufactured of high strength ductile iron in accordance with ASTM A536, Grade 65-45-12. Wedge inserts are heat-treated to a hardness of 370 BHN minimum.
<b>Pressure Rating:</b>	3"-16" 350 psi WWP 18"- 64" 250 psi WWP
<b>Factor of Safety:</b>	2:1
<b>Size Range:</b>	3" - 64"
<b>Approvals:</b>	Underwriters Laboratories' listed in sizes 3"-36" and Factory Mutual approved in sizes 3"-12".
<b>Deflection:</b>	5° on 3"- 12", 2° on 14" & 16", 1.5° on 18"- 30" and 1° on 36"- 64"
<b>Dimension:</b>	Conform to ANSI/AWWA C111/A21.11 & ANSI/AWWA C153/A21.53 standards
<b>Traceability:</b>	Gland body, wedge inserts and break-off top actuating bolts are individually cast with exact heat code information.
<b>Installations:</b>	In accordance with manufacturer's recommendation and applicable AWWA standards.



# ONE-LOK™ MODEL SLDE WEDGE ACTION RESTRAINT FOR DUCTILE IRON PIPE

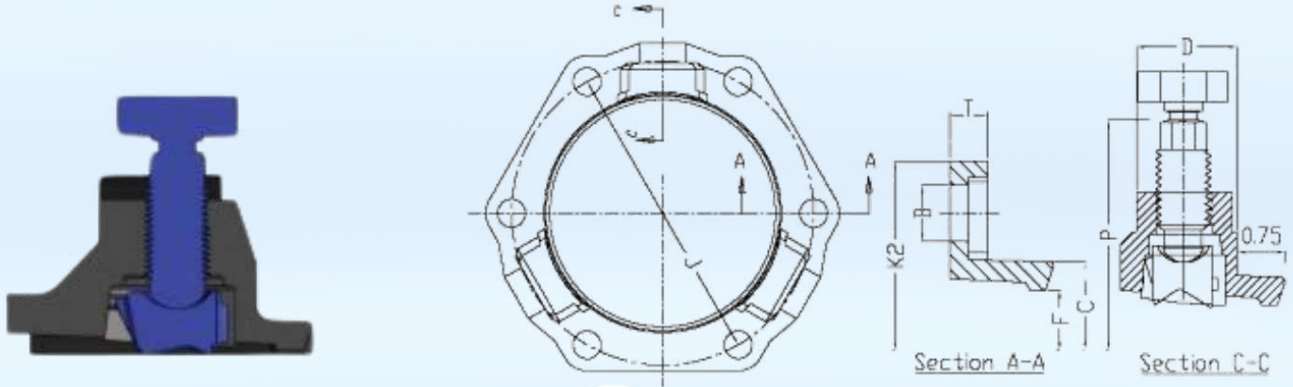

## ONE-LOK™ Series SLDE for Ductile Iron Pipe

All dimensions are in inches

Nom Pipe Size	Wgt	DI Pipe OD	Steel Pipe OD	Dimensions								Bolts & Inserts			Pressure Rating	T-Bolts			Gasket No
				C	F	D	T	P*	B	J	K2	No	Size	Torque		No	Size	Torque	
3	5.50	3.96	---	4.84	4.16	1.58	0.55	9.40	0.750	6.19	7.69	2	7/8	75-90	350	4	5/8 x 3.0	45-60	1
4	6.50	4.80	4.50	5.92	5.00	1.58	0.55	10.24	0.875	7.50	9.12	2	7/8	75-90	350	4	3/4 x 3.5	75-90	1
6	10.00	6.90	6.625	8.02	7.10	1.58	0.60	12.34	0.875	9.50	11.12	3	7/8	75-90	350	6	3/4 x 3.5	75-90	1
8	14.50	9.05	8.625	10.17	9.25	1.63	0.75	14.32	0.875	11.75	13.37	4	7/8	75-90	350	6	3/4 x 4.0	75-90	1
10	23.00	11.10	10.75	12.22	11.30	1.58	0.85	16.54	0.875	14.00	15.62	6	7/8	75-90	350	8	3/4 x 4.0	75-90	1
12	29.00	13.20	12.75	14.32	13.40	1.58	0.85	18.80	0.875	16.25	17.88	8	7/8	75-90	350	8	3/4 x 4.0	75-90	1
14	39.60	15.30	---	16.40	15.55	1.58	1.125	21.20	0.875	18.75	20.25	10	7/8	75-90	350	10	3/4 x 4.5	75-90	1
16	49.67	17.40	---	18.50	17.54	1.77	1.21	23.74	0.875	21.00	22.50	12	7/8	75-90	350	12	3/4 x 4.5	75-90	1
18	60.33	19.50	---	20.60	19.64	1.77	1.25	25.84	0.875	23.25	24.75	12	7/8	75-90	250	12	3/4 x 4.5	75-90	1
20	69.00	21.60	---	22.70	21.74	1.87	1.25	27.94	0.875	25.50	27.00	14	7/8	75-90	250	14	3/4 x 5.0	75-90	1
24	103.67	25.80	---	26.88	25.95	1.92	1.47	32.14	0.875	30.00	31.50	16	7/8	75-90	250	16	3/4 x 5.0	75-90	1
30	158.67	32.00	---	33.29	32.17	2.13	1.65	39.30	1.125	36.88	39.12	20	1.00	115-125	250	20	1 x 6.5	100-120	1
36	234.50	38.30	---	39.59	38.47	3.15	1.75	46.07	1.125	43.75	46.00	24	1.00	115-125	250	24	1 x 6.5	100-120	1
42	344.00	44.50	---	45.79	44.67	3.56	2.25	53.25	1.38	50.62	53.38	28	1 1/4	115-125	250	28	1 1/4 x 8.0	120-150	1
48	456.00	50.80	---	52.09	50.97	3.81	2.25	59.55	1.38	57.5	60.26	32	1 1/4	115-125	250	32	1 1/4 x 8.0	120-150	1
54	1045.00	57.56	---	58.85	57.73	6.00	4.50	70.43	1.375	63.20	67.50	18	1 1/2	400 +/- 5	250	36	1 1/4 x 11.0	120-150	1
60	1136.00	61.61	---	62.90	61.78	6.00	4.50	74.52	1.375	67.72	72.00	18	1 1/2	400 +/- 5	250	36	1 1/4 x 11.0	120-150	1
64	1258.00	65.67	---	66.96	65.84	6.00	4.50	78.68	1.375	71.86	76.00	19	1 1/2	400 +/- 5	250	38	1 1/4 x 11.0	120-150	1

### Notes:

- ONE-LOK SLDE was previously referred to as model SLD.
- P\* Dim shows OD after head is broken/removed.
- SLDE 4" - 12" can be used on Steel Pipe - Sch 40 & above with Transition Gasket.
- Sizes 3"-12" is approved for thinnest class of DI pipe.

Sizes 3" - 14" are UL listed for 350 psi on DI Pipe  
 Sizes 16" are UL listed for 300 psi on DI Pipe  
 Sizes 18" - 30" are UL listed for 250 psi on DI Pipe  
 Sizes 36" are UL listed for 200 psi on DI Pipe  
 Sizes 42" and 48" are pressure rated at 250 psi on DI Pipe  
 Sizes 54", 60" and 64" are pressure rated at 250 psi on DI Pipe  
 Sizes 4" - 12" are FM approved for 175 psi on DI pipe.

